

# MERIDIAN AVENUE

FILED WATER & SEWER IN PT R/W  
GREENVILLE CO. S. C.

SEP 13 9 46 AM '84  
DONNIE S. ANNERSLEY  
R.M.C.

Note:  
Improvements  
on this lot  
are not in  
a flood hazard  
area.

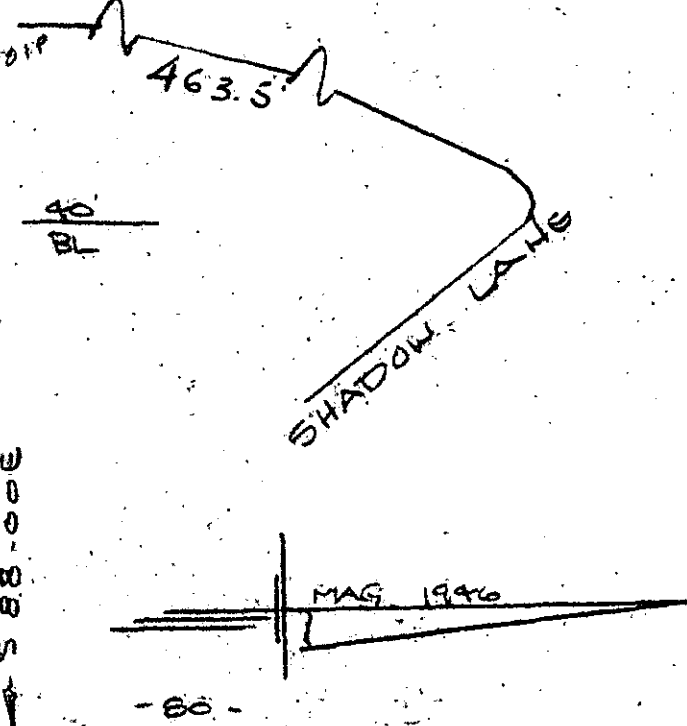
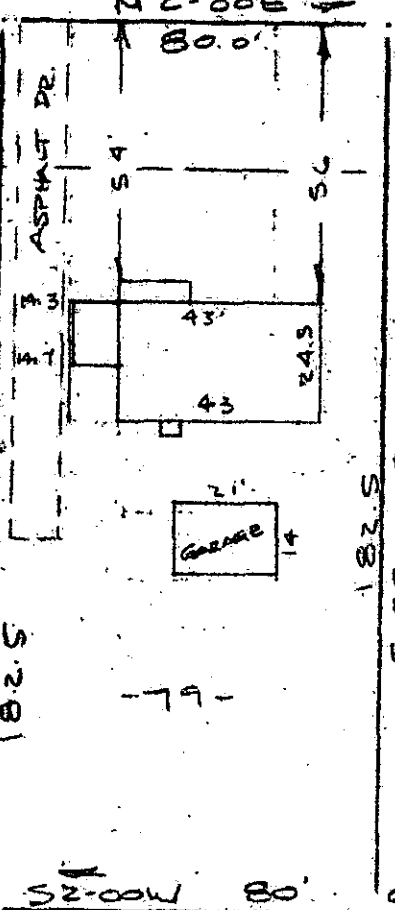

- 78 -                      - 79 -                      - 80 -

PROPERTY OF  
**HOWARD K. WILLIAMS & JEAN C. WILLIAMS**  
NEAR GREENVILLE, S.C.  
SCALE 1" = 40'                      5 SEPT 1984

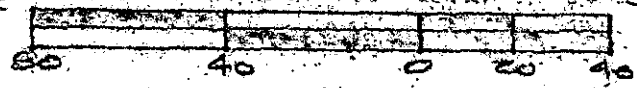

This is to certify that on the 5th day of September, 1984, I surveyed the property shown on this plat, being known as lot 79 on plat of MAP OF SUPER HIGHWAY HOME SITES and recorded in the RMC Office Greenville County, S. C., in Plat Book " P " at Page 53; and that the property lines, walls and buildings are as shown hereon, and that the walls and buildings located on said lot do not encroach or project on adjacent street or property, and that no adjacent walls or buildings encroach or project on said premises, and no power lines cross this property except as shown hereon.

10-Y-16

8215

*R. B. Bruce*  
R. B. Bruce, RLS # 1952

SEP 13 1984

CAROLINA SURVEYING CO.  
112 Manly St.  
Greenville, S. C.

Recordable Plat

P15.3-5-15

286/a

SE1384 109